

NUNAVUT

Long-term Care Centre Rankin Inlet

Design Information



New Long-term Care Centre in Rankin Inlet

The Departments of Health (Health) and Community and Government Services (CGS) are proud to announce the addition of a new facility to our ever-growing continuing care services: planning and design is underway for a new, 24-bed long-term care centre in Rankin Inlet.

In 2014, Health initiated a needs assessment of long-term care (LTC) in Nunavut. The needs assessment focused on LTC for seniors with chronic physical or cognitive disability or illness, excluding mental health or addictions treatments.

The needs assessment confirmed that the continuing care system in Nunavut is beyond capacity and does not meet the needs of Nunavummiut. Nunavummiut care for their elderly family members who have complex needs, chronic illness, or disabilities, as best as they can in often overcrowded homes. Home-care support is provided where available; however, the caregiving process can be lengthy and demanding. When it is no longer feasible to receive care at home, individuals are assessed and wait for care to be provided in Nunavut or out-of-territory.

The Kivalliq Region is in urgent need of new long-term care beds. The facility and all that it entails must be reflective of and responsive to the culture, values, history, and traditions of Nunavummiut in general, and Inuit specifically. It is also a model that provides for *ageing in place in a safe place*. It is intended that the facility design invoke a strong sense of pride. Culture must be both recognized and celebrated within and by the physical structure as well as in day-to-day activities. This can be achieved, for example, through cultural activities and provision of appropriate country foods.

It is intended that the new facility will be designated to provide both Level 2 and Level 3 assisted living

residential care as well as Level 4 and/or Level 5 care for those individuals with more complex needs, such as dementia, when the program delivery matures. (See diagram)

The dementia journey varies from person to person, and the aim is to provide specialized support and care through this journey at this facility, as the program matures. Families and caregivers will be care partners and involved in the day-to-day life of residents where possible. Family members will be welcomed and encouraged to be active participants in their family member's care.

The new Long-term Care Centre demonstrates Health's commitments to providing a high level of care to Nunavummiut who require ongoing supports in their homes, supportive living arrangements or 24/7 access to nurses and supportive care.

Models of care and associated building design(s) have changed dramatically in the last two decades. In most jurisdictions, long-term care has moved to a model which is dramatically more resident-focused or person-centered with a home-like atmosphere instead of the institutional or medical model.



Multi-Purpose Room

The multi-purpose room will be located adjacent to the building's main entrance with large windows facing the community. The room will be designed in a circular form to accommodate various events and allow staff, residents and community members to utilize the space from large gatherings to small intimate events.

LEVELS OF CARE

with examples

Mary, 43, lives alone in her own home. She has arthritis and can manage most tasks, but receives support for light housekeeping from home and community care.

Level 1



hours of care



LEVEL 1: The client can live in her own home independently with occasional support from family members and/or the home care program.

Level 2

Pauloosie, 55, has a heart condition. He needs help with bathing and meal preparation. He and his family are supported by home and community care.



hours of care



LEVEL 2: The client requires some assistance to be mobile, may display some behavioural issues and requires minimal to moderate daily support, all of which can be provided at home with significant support from the home care program or in a facility that provides supportive care.

Jacobie, 62, needs evening and weekend care that is not available from home and community care, so he requires placement in an Elders Home.

Level 3



hours of care



LEVEL 3: The client requires care and support that can be provided at home with significant support from the home care program or in a facility that provides supportive care.

Level 4

Solomon, 92, had a severe stroke. He now has physical disabilities and cognitive decline. He requires placement in a Long-term Care Centre.

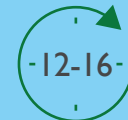

hours of care



LEVEL 4: The individual requires significant care and support that exceeds what can be provided at home and requires placement in a Long-term Care Centre.

Rita, 76, is in the late stage of dementia. She is non-verbal and wanders. She requires placement in a secure dementia care unit.

Level 5



hours of care



LEVEL 5: The individual requires 24-hour supervision and care. May include Nunavummiut who have been diagnosed with dementia.

Respite Care

Services that provide caregivers with temporary relief from tasks associated with caregiving.





The goal is for the new long-term care centre to implement the person-centred model fully in Nunavut.

Although this is a territorial facility, all efforts will be made to provide care to Nunavummiut as close to home as possible. Residents aged 55 years and older will be accepted based on assessed need. These facilities will not be seniors' housing, adult living, or a hospital. They are to provide medical supervised continuing care.

Both programs and design will be embracing Inuit Qaujimagatunqangit and Inuit Societal Values, in line with the Government of Nunavut's mandate to better represent the people it serves. A culture borne of respect and dignity will be provided and shown for all Nunavummiut. Privacy and dignity are paramount in the care provided to residents, and independence and individual preferences will be

emphasized. Country food will be prioritized for residents when available.

The outbreak of COVID-19 has reinforced the need for strict infection control measures. Infection control best practices will be incorporated into both the model of care and the design of the facility, such as anti-microbial surfaces, state-of-the-art ventilation, single occupancy resident rooms with private bathroom, and dedicated household staff.

The Long-term Care Centre will be located between the Rankin Inlet Health Centre and the recently constructed Rankin Arena. The facility will have a service entrance facing the Rankin Arena with the main building entrance and parking lot facing Tupirvik Avenue and the town of Rankin Inlet.

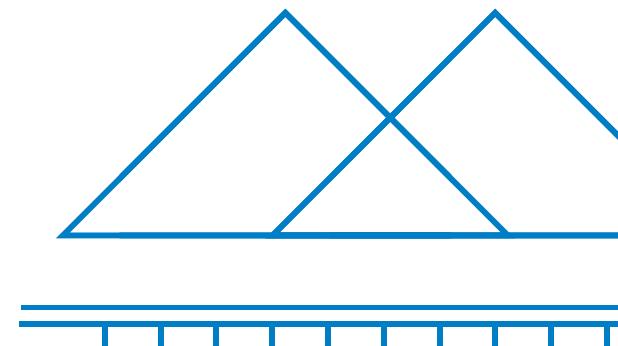

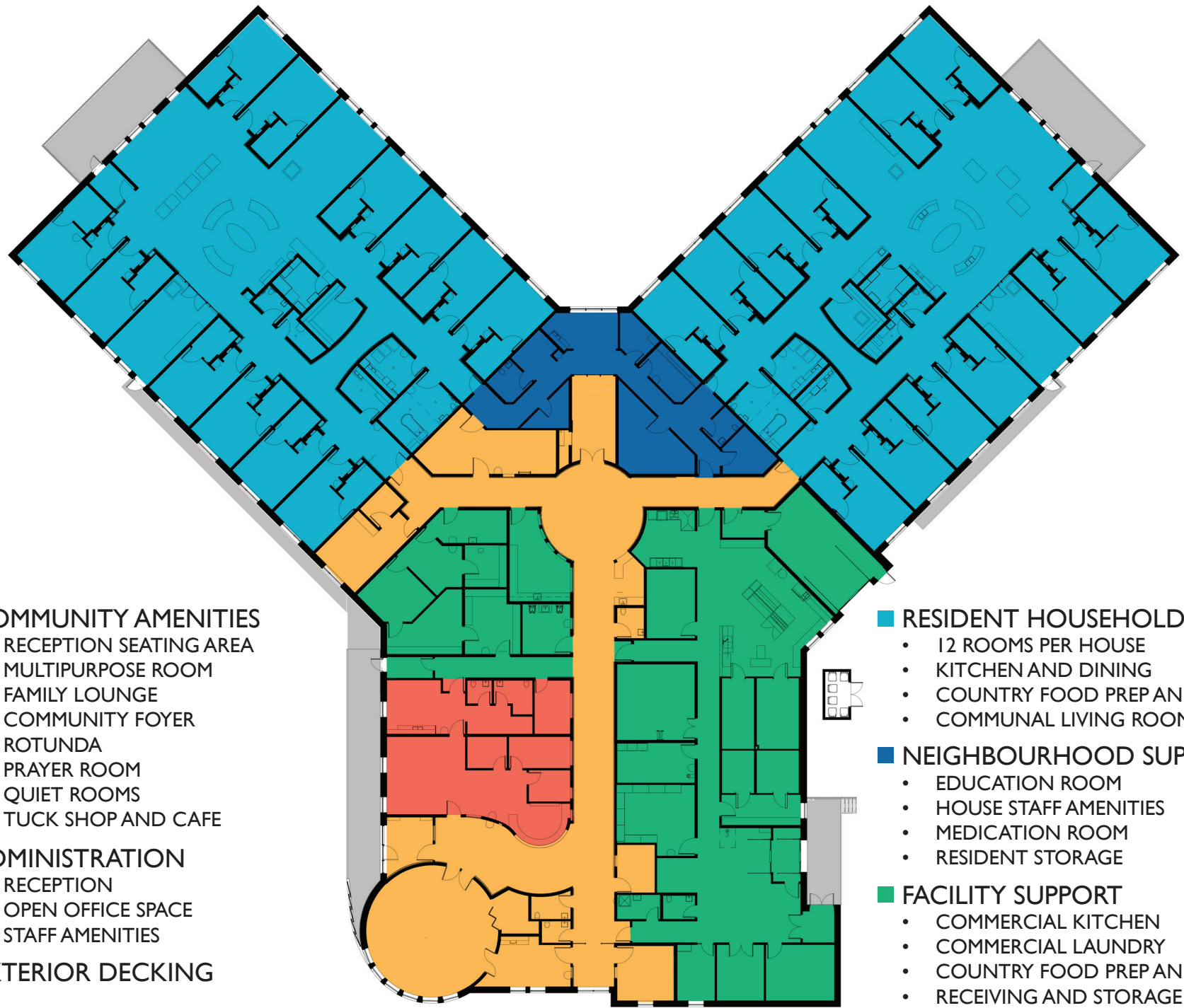

COMMUNITY AMENITIES

- RECEPTION SEATING AREA
- MULTIPURPOSE ROOM
- FAMILY LOUNGE
- COMMUNITY FOYER
- ROTUNDA
- PRAYER ROOM
- QUIET ROOMS
- TUCK SHOP AND CAFE

ADMINISTRATION

- RECEPTION
- OPEN OFFICE SPACE
- STAFF AMENITIES

EXTERIOR DECKING

RESIDENT HOUSEHOLDS

- 12 ROOMS PER HOUSE
- KITCHEN AND DINING
- COUNTRY FOOD PREP AND DINING
- COMMUNAL LIVING ROOMS AND DEN

NEIGHBOURHOOD SUPPORT

- EDUCATION ROOM
- HOUSE STAFF AMENITIES
- MEDICATION ROOM
- RESIDENT STORAGE

FACILITY SUPPORT

- COMMERCIAL KITCHEN
- COMMERCIAL LAUNDRY
- COUNTRY FOOD PREP AND STORAGE
- RECEIVING AND STORAGE



Entrance Foyer

The entrance will be inviting and warm. The entrance foyer will provide a sitting area near the building entrance and direct connection to the multi-purpose room. The circular form of the multi-purpose room will continue into the foyer with a curved wall finished with stone and a built-in bench.



Rotunda

The Rotunda with connected café and tuck shop (canteen) is located at the core of the building between the corridors leading to the two resident houses. The circular space will be flexible to provide a space where residents and family can sit together outside the household.



Resident House Common Area

Each household will have 12 resident rooms sharing a kitchen for assisted meal preparation and designated country food gathering area. The design will encourage residents to come out of their rooms and partake in different activities provided. Residents can get a snack, listen to the local radio, or watch a movie. Views are emphasized to connect the outside in. The common area will be designed to emphasize scenic views and the connection to the land. Elements could include murals depicting Nunavut's history and landscape and built-in memory boxes next to each room to display personal mementos.



Resident Room

Resident rooms will be designed with a home-like and relaxing environment in mind. A large window will provide vast views to the outdoors with deep windowsills to allow residents to store personal keepsakes. Care will be taken to ensure privacy and dignity for each resident. Each room will have its own private bathroom, encouraging independence.

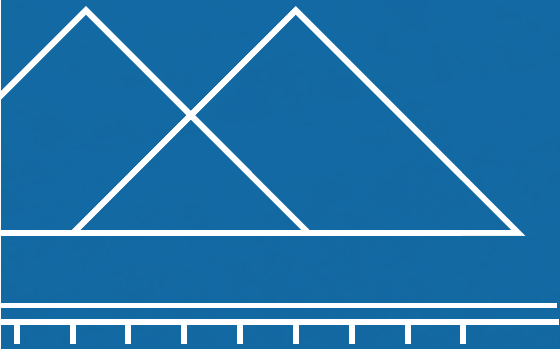

For further information or feedback contact:

Home and Continuing Care Division

Department of Health

P.O. Box 1000, Station 1000

Iqaluit, Nunavut

X0A 0H0

Tel: 867-975-5941

Email: LTC@gov.nu.ca

